

FNR-1004

REV	OCN #	DATE	APR
2	042669	21 APR 08	KKK

NOTES:

1. CHANGE OF MATERIAL IS NOT PERMITTED UNLESS APPROVED IN WRITING BY OTTO ENGINEERING PERSONNEL.
2. DRAWING TO BE INTERPRETED IN ACCORDANCE WITH THE CURRENT REVISION OF ASME Y14.5M.
3. THIS PART/PRODUCT IS TO BE MANUFACTURED WITH THE APPLICABLE REGULATIONS OF EC DIRECTIVES 2002/95/EC AND 2002/96/EC, RESTRICTION OF THE USE OF HAZARDOUS SUBSTANCES IN ELECTRICAL AND ELECTRONIC EQUIPMENT (RoHS) AND WASTE ELECTRICAL AND ELECTRONIC EQUIPMENT (WEEE).

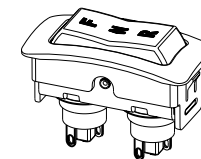
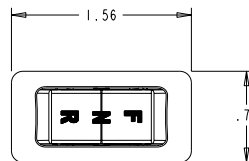

SCALE 1:1

CHARACTERISTICS:

ELECTRICAL:

ELECTRICAL RATINGS:

RATINGS AT 28 VDC		
LOAD	SEA LEVEL	50,000 FT.
RESISTIVE	4 AMPS.	4 AMPS.
INDUCTIVE	2 AMPS.	2 AMPS.

ELECTRICAL LIFE: 25,000 CYCLES

MECHANICAL:

MECHANICAL LIFE: 1,000,000 CYCLES

ACTUATION FORCE:

FORWARD / REVERSE TO NEUTRAL: 1.60±.75 LBS.  
NEUTRAL TO FORWARD / REVERSE: 2.80±.75 LBS.

PHYSICAL:

TEMPERATURE RANGE:

STORAGE: -50°C TO +85°C  
OPERATING: -40°C TO +85°C

SEAL: INTERNAL SWITCH MECHANISM  
SEALED PER IP-68

MARKING:

OTTO  
FNR-1004  
DATE CODE (YYWW)

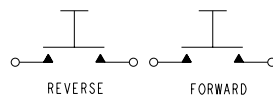
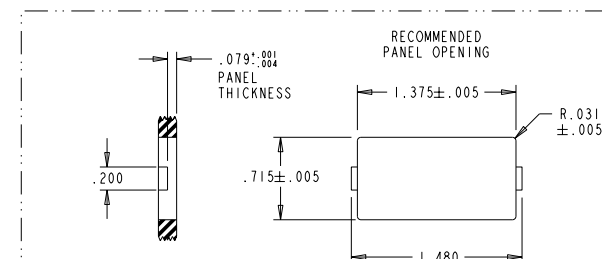
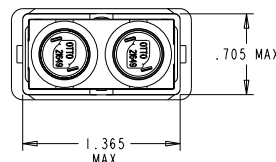
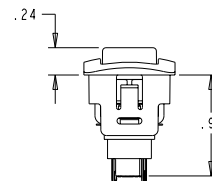
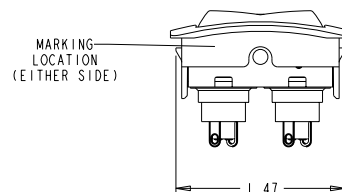

SCHEMATIC  
(SHOWN IN NEUTRAL)

- MANUFACTURING
- ▲ SPC

UNLESS OTHERWISE SPECIFIED:  
DIMENSIONS ARE IN INCHES.  
TOLERANCES:  
.XX ±.03  
.XXX ±.010  
ANGLES ±2°  
DO NOT SCALE

**OTTO**  
CARPENTERSVILLE, ILLINOIS USA

THIS DOCUMENT IS THE CONFIDENTIAL PROPERTY OF OTTO ENGINEERING, INC.. IT IS NOT TO BE USED IN ANY WAY DETRIMENTAL TO THE INTERESTS OF OTTO ENGINEERING, INC..

DESCRIPTION

FNR, SWITCH,  
OTTO UNIVERSAL

DRWN. KS	SIZE	FSCM NO	DRAWING NO.	REV.
CHKD. KKK	B	21649	FNR-1004	2
APPD. AH	THIRD ANGLE PROJECTION		Scale 1:1	Sheet 1 OF 1
WT.				